

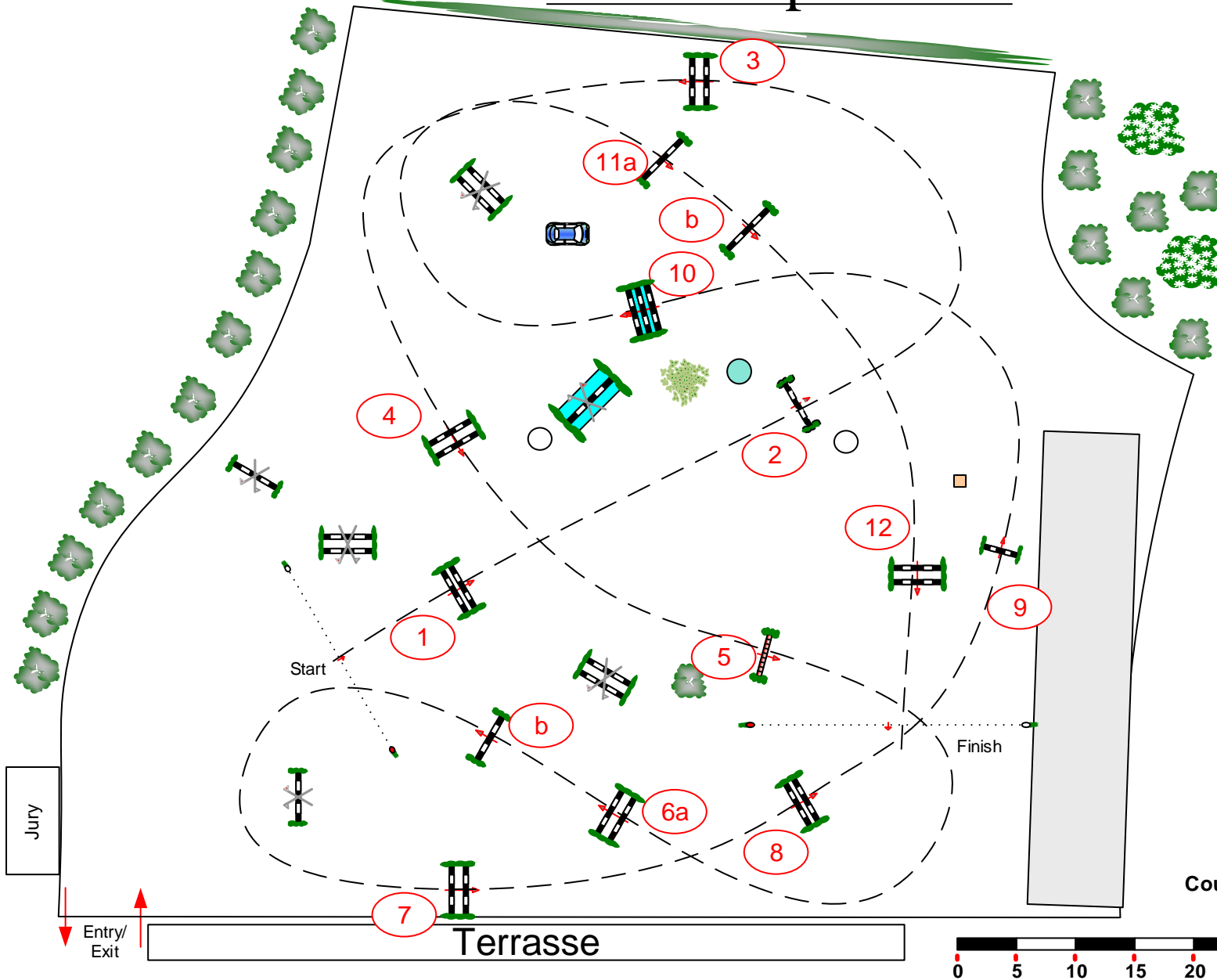

# CSI-CH/J/U25-A/CSI1\*/CSIYH1\*

## Eschweiler Young Masters

### 23.-26. April 2015



Class No.: **2**

CSI\* Diamond Tour

Competition acc. to penalties and time

Donnerstag, 23. April 2015

Start: 13:00

Table: A  
 National RG:  
 FEI RG / Art. 238.2.1  
 Height: 1,35 m

Speed: 350 m/min

Length: 460 m

Time allowed: 79 sec

Time limit: 158 sec

1st Jump-off:

Length: 0 m

Time allowed: 0 sec

Time limit: 0 sec

Obstacles: 12

Efforts: 14

Course Designer: Matthias Rosellen/GER & Team